

# 3-AXIS HIGH SPEED LINEAR DRIVE DIE SINKER E.D.M



- HIGH MACHINING SPEED
- LESS ELECTRODE WEAR
- HIGH PRODUCTIVITY

## FEATURE

### Compact Floor Layout

All-in-one design to save occupied space by 10%.

### X, Y, Z Axis Linear Drive

Highly rigid column moving structure design attached with X、Y、Z axis Linear Motors to gain high speed, backlash-free, high precision machining.

### Air Balance Spindle

Cutting speed can be increased up to 4 times and high responsiveness possible by Linear Motor and air balance system. It can have good machining result on tiny and deep hole, also rib job.



### User Friendly

Friendly conversation window is available. Suitable working condition easily and quickly come up by just select the type of E code.

### High Speed+Energy Saving

Revolutionary Energy Saving HSC and ESC. Machining speed is enhanced by over 30% under identical low wear rate through controllable discharge wave.

## HIGH SPEED MOVEMENT

	LINEAR Motor	Ball-Screw
Traverse Speed	18 - 21 m / min	2 - 5 m / min
Positioning Lag	NO	YES
Structure		

## HIGH PERFORMANCE EXAMPLE

Electrode : (Cu) 60x60mm 2pcs
Workpiece : NAK80
Depth : 2.70mm
Machining Time : 13hr 05min (Rough=3hr 35min; Finish=9hr 30min)
Roughness [Ra] : 0.50μmRa



# FLOOR LAYOUT

## A5030L LINEAR MOTOR DRIVE 單位:mm

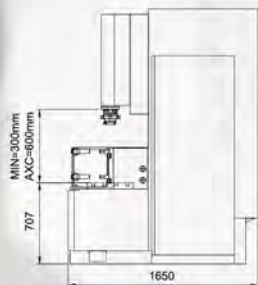
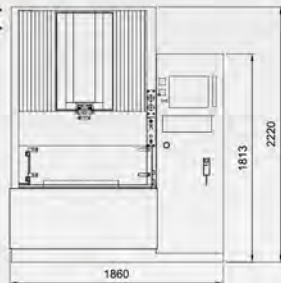

## A6040L LINEAR MOTOR DRIVE 單位:mm

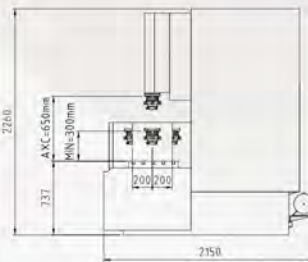
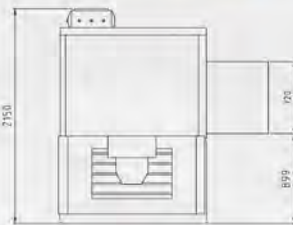

# SPECIFICATION

ITEMS	單位 (UNIT)	A5030L	A6040L
Work Table Size (WXD)	mm	650x400	800x500
Work Tank Size (WXDXH)	mm	1100x640x400	1200x740x450
Max. Job Load Size (WXDXH)	mm	850x550x300	1050x700x300
Table Travel (X, Y)	mm	500x350	600x400
Table Travel (Z)	mm	300	350
X, Y, Z Axis Drive	mm	X,Y,Z Axis By Linear Motor	X,Y,Z Axis By Linear Motor
Distance from Ram platen to work table	mm	300~600	250~600
Max. Electrode Weight	kg	30	50
Max. Work-piece Weight	kg	1000	1500
Outside Dimensions (WXDXH)	mm	1860x1650x2220	2100x2150x2260
Net Weight	kg	2230	3000
Pneumatic Requirement	kgf/cm <sup>2</sup>	6	6
For Dielectric Tank	—	DA53	DA64

### Optional Accessories

3 Pos. ATC	<input checked="" type="checkbox"/>
4 Pos. ATC	<input checked="" type="checkbox"/>
C-Axis	<input checked="" type="checkbox"/>
Magnet Base	<input checked="" type="checkbox"/>
Auto Fill & Drain	<input checked="" type="checkbox"/>
B Axis	<input checked="" type="checkbox"/>
Manual Drop Door	<input checked="" type="checkbox"/>
Tungsten Circuit	<input checked="" type="checkbox"/>
Oil Cooler	<input checked="" type="checkbox"/>

Note :

- ◎ B Axis can be operated only under flushing circumstance.
- ◎ System 3R and EROWA ATC and C Axis are offered as options.

POWER SUPPLY UNIT	UNIT	50N	75N
Max. Machining Current	A	50	75
Max. Power Input	KVA	5	6
Electrode Wear Rate	%	0.2	0.2
Bset Surface Roughness	µm/Ra	0.25	0.25
Outside Dimensions(wxdxh)	mm	Built in	Built in
Weight	kg	Built in	Built in

DIELECTRIC	UNIT	DA53	DA64
Volume	L	480	635
Filter	method	Paper Filter	
Power	HP	0.5	
Weight	kg	Built in	
Outside Dimensions	mm	Built in	

※ The manufacturer reserves the right to modify the design for specification, mechanisms, etc. to improve the performance of the machine without notice, all the specifications above are just for reference.